

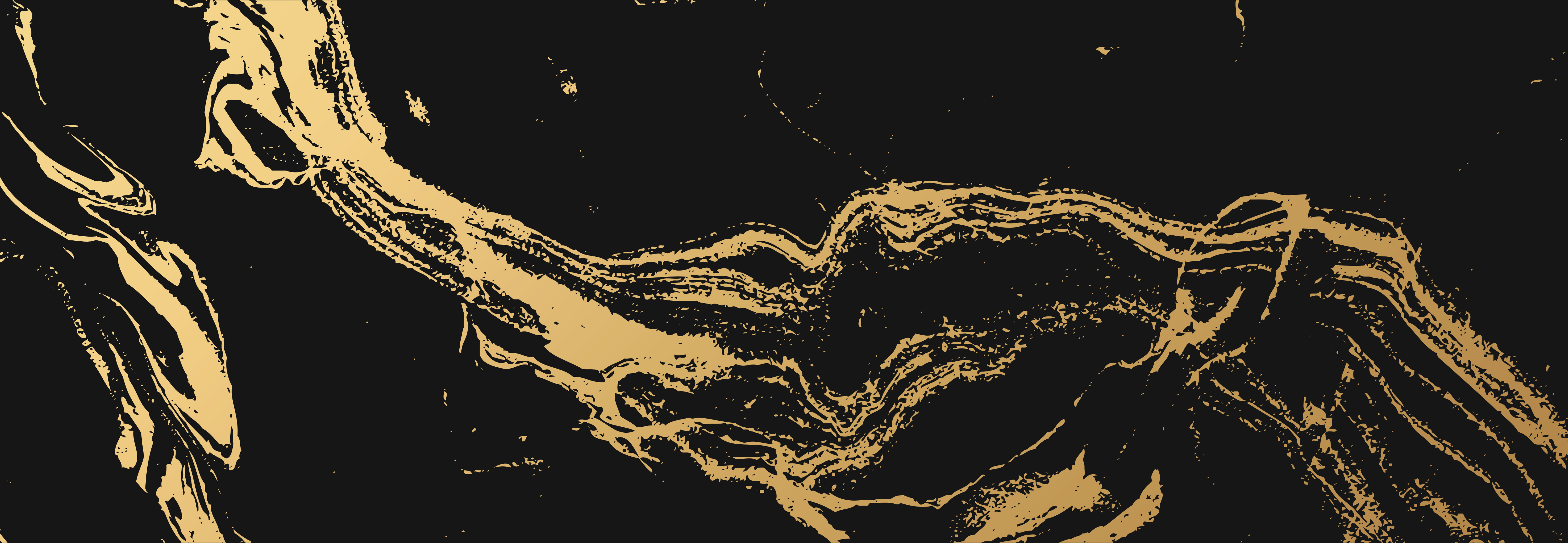

GUJRANWALA
EMPORIUM





بِسْمِ اللَّهِ الرَّحْمَنِ الرَّحِيمِ

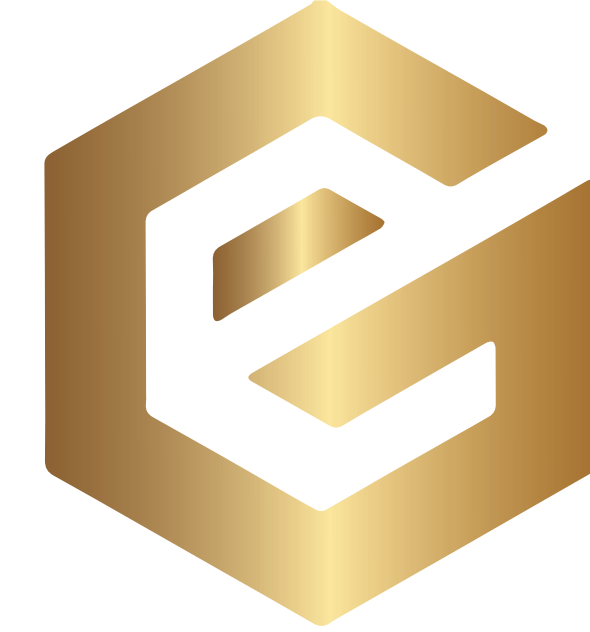

GUJRANWALA

EMPORIUM

THE MOST PREMIUM SHOPPING DESTINATION



ABOUT GUJRANWALA EMPORIUM

GEM OF GUJRANWALA CITY

Gujranwala Emporium is home to everything from renowned fashion brands to emerging concepts and goods. It gives a sterling opportunity to become a brand among brands in the hub of opportunities. Soon Gujranwala Emporium will be named as next commercial hub of Gujranwala City because it will be the one stop solution for all the people of the city when it comes to luxury and shopping all around.





THE MOST
Premium
SHOPPING DESTINATION

ABOUT DEVELOPER

A NAME OF TRUST AND RELIABILITY

Sufi Abdul Ghani is a renowned name in the modern era of real estate development. After the enormous success in the construction and building sector of real estate, now bringing one of the best and stellar project on main DC road Gujranwala. SAG group is now aiming to provide Gujranwala's urban landscape a much-needed boost by acknowledging society's new-age lifestyle needs. SAG group is destined and bound to fulfil the promises they keep and deliver their projects within a mentioned timespan and offer stunning ROI to their investors and customers.

The logo features the letters 'SAG' in a large, bold, gold-to-brown gradient font. Below it, the name 'SUFI ABDUL GHANI' is written in a bold, black, sans-serif font. Underneath the name is a thin gold horizontal line, followed by the text 'BUILDERS & DEVELOPERS' in bold black, and 'SMC-PRIVATE LIMITED' in a smaller, spaced-out black font. The background includes a large, faint 'SAG' watermark and a detailed illustration of a tree trunk with roots in shades of gold and brown.

SAG
SUFI ABDUL GHANI
BUILDERS & DEVELOPERS
SMC-PRIVATE LIMITED





REALITY
TO YOUR
IMAGINATION

ABOUT MARKETING COMPANY

EXCLUSIVE MARKETING PARTNER

Marketing 360 has only one vision and it is to transform the real estate structure of Pakistan with innovation and new marketing tactics to make sure that their customers can cherish the every ounce of safest future.

Reliable, Experienced, Innovative, & highly resourceful professionals who started their journey back in 2016 with the aim to provide buyer & seller the best possible options through our people who value relationship over transactions.



ABOUT CITY

CITY OF WRESTLERS

It is also known as "City of Wrestlers" and is quite famous for its food. The city is Pakistan's 5th most-populous metropolitan area, as well as 5th most populous city proper after Karachi, Lahore, Faisalabad and Rawalpindi respectively. Currently there are many commercial projects ongoing in this beautiful city to facilitate the people of the city so that they can find everything they need within their reach. But, there has been no project so far which houses all the brands under one roof. So Gujranwala Emporium is going to be the next landmark of this incredible city.

ABOUT ARCHITECTS

CREATING INSPIRING DESIGNS



The architects of this amazing project are well reputed name when it comes to deliver the excellency. Gujranwala Emporium is a Thematic Shopping Destination based on the concept of Arabic Souqs & Turkish Market Places in the heart of the City, where customers will have a very unique and diverse shopping experience. So, to bring in this diversity, class and elegance in Gujranwala, Builtron Architects have played a major role to reshape the luxury in Gujranwala.





IDEAL LOCATION

On Main DC Road,
GUJRANWALA

-  3-5 MINS DRIVE
-  SPACIOUS PARKING
-  IN THE HEART OF CITY





Architecture *Design*

- 🏡 inspired by Arabic Souq & Turkish Market architecture
- 🏡 Spacious inside out
- 🏡 Wide shop frontage to increase your retail visibility
- 🏡 Gated Marketd place for all your needs
- 🏡 Thematic Design
- 🏡 Open outdoor spaces, connected with beautiful boulevards
- 🏡 Central activity hub

WHAT WE
OFFER



SHOPS &
OFFICES



COMMERCIAL SPACES

- BANKS
- SHOPS
- SUPER MARKET
- CLOTHING BRAND
- MOBILE STORES
- DISPLAY CENTERS
- HEALTH CARE CENTERS



Lower
GROUND



Kul Ahmed

Outfitters

alkaram

BREAKOUT

Prestige

Kul Ahmed

BABY SHOP

Ground + First
FLOOR



320 SQ.FT
ENTRANCE



AMENITIES

Gujranwala Emporium is designed and developed with the purpose of delivering something useful, convenient, or entertaining to residents of Gujranwala under one single roof.



SPACIOUS LOBBY

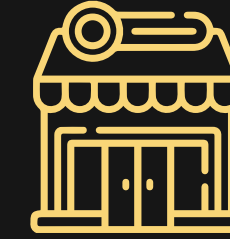

DESIGNED SHOPS

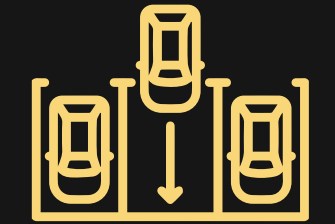

DESIGNED SHOPS



GATED COMMUNITY



PRAYER AREA



KIDS PLAY AREA



24/7 SECURITY

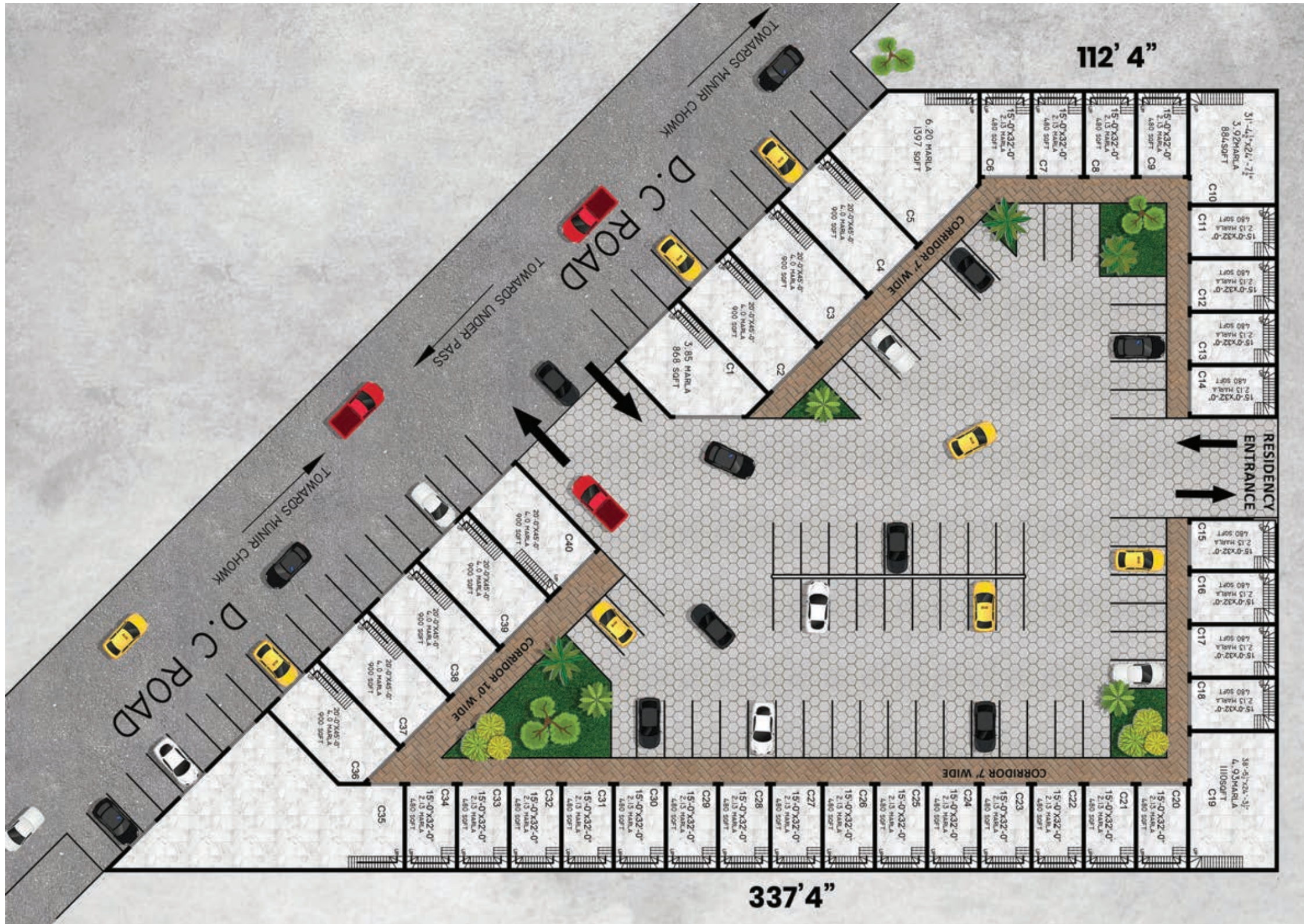

GUJRANWALA
EMPORIUM

FLOOR PLANS

10
KANAL

03
STORIES

70+
SHOPS



YOUR NEXT
LIFETIME
INVESTMENT

BROUGHT TO YOU BY

This one stop solution for the residents of Gujranwala will be completed in a mentioned timeframe because the people behind the delivery of this project are highly very professional, humble and dedicated towards their promises. Insha Allah, Gujranwala Emporium will soon reshape the commercial activities of the City.



DEVELOPED BY

SAG

SUFI ABDUL GHANI

BUILDERS & DEVELOPERS
SMC-PRIVATE LIMITED

ARCHITECT BY



BUILTRON
ARCHITECTS

MARKETED BY





GUJRANWALA

EMPORIUM



www.gujranwalaemporium.com

Main DC Road Near Gulzar Hospital Gujranwala